

REF.	DESCRIPTION	WM / HM / FS	MODEL	ELEMENT	OUTPUT (W)	VOLTAGE
241040	TH BLINDE VM 050L 1200M	WM	50	SHEATHED	1200	220-240V
241039	TH BLINDE ETROIT VM 050L 2000M	WM	50	SHEATHED	2000	220-240V
251054	TH BLINDE VM 075L 1200M	WM	75	SHEATHED	1200	220-240V
261128	TH BLINDE VM 100L 1200M	WM	100	SHEATHED	1200	220-240V
251084	TH BLINDE VM 150L 1600M	WM	150	SHEATHED	1600	220-240V
251085	TH BLINDE VM 200L 2200M	WM	200	SHEATHED	2200	220-240V
861511	TH BLINDE COMP VM 100L 1200M	WM	100	SHEATHED	1200	230V
861512	TH BLINDE COMP VM 150L 1600M	WM	150	SHEATHED	1600	230V
861513	TH BLINDE COMP VM 200L 2200M	WM	200	SHEATHED	2200	230V
853408	TH BLINDE HM 075L 2000M RACC COTE	HM	75	SHEATHED	2000	220-240V
853409	TH BLINDE HM 100L 2000M RACC COTE	HM	100	SHEATHED	2000	220-240V
853410	TH BLINDE HM 150L 2000M RACC COTE	HM	150	SHEATHED	2000	220-240V
853411	TH BLINDE HM 200L 2000M RACC COTE	HM	200	SHEATHED	2000	220-240V
253011	TH BLINDE HM 075L 1600M RACC DESSOUS	HM	75	SHEATHED	1600	220-240V
253014	TH BLINDE HM 100L 1600M RACC DESSOUS	HM	100	SHEATHED	1600	220-240V
253021	TH BLINDE HM 150L 2200M RACC DESSOUS	HM	150	SHEATHED	2200	220-240V
253023	TH BLINDE HM 200L 2200M RACC DESSOUS	HM	200	SHEATHED	2200	220-240V
282030	TH BLINDE VS 200L 2200M	FS	200	SHEATHED	2200	220-240V
282031	TH BLINDE VS 300L 3000M	FS	300	SHEATHED	3000	220-240V
292001	TH BLINDE COMP VS 500L 5000TC	FS	500	SHEATHED	5000	TC

**KEY SELLING POINTS & PRODUCTS ADVANTAGES**

	Copper heating element		Large choice of models for all needs
	Magnesium anode		Enhanced design for a better handling
	Temperature regulation		

	GENERAL SPECIFICATION
HEATING ELEMENT	DRY
HEATING ELEMENT MATERIAL	COPPER
TANK PROTECTION 1	MAGNESIUM ANODE
TANK PROTECTION 2	NO
TANK MATERIAL	ENAMELED STEEL
EXTERNAL MATERIAL	PAINTED STEEL
INSTALLATION TYPE	WM/HM/FS
PRODUCT MAIN COLOR	WHITE
TOP COLOR	WHITE (new design)
BOTTOM COLOR	WHITE (new design)
PLASTIC ROUND COLOR	N/A
HMI COLOR	N/A
PLUG	NO CABLE
THERMOSTAT	MECHANICAL THERMOSTAT
SAFETY VALVE	N/A
DIELECTRIC UNION	BI-METAL x1
THERMOMETER	NO
STANDARD	CE; NF
IP RATINGS	WM IP25/HM & FS IP24

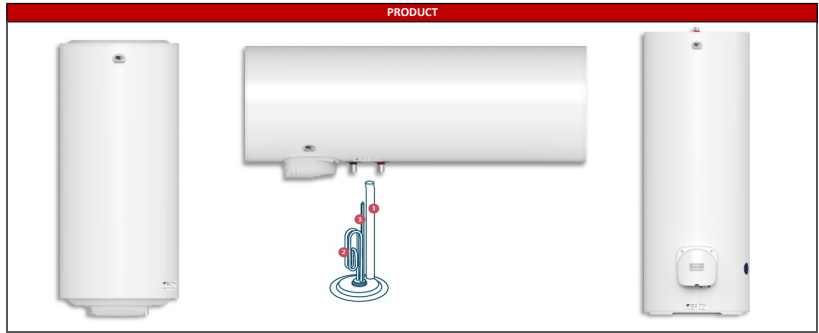

**... TRANSLATED INTO :**  
Languages  
French, Netherland

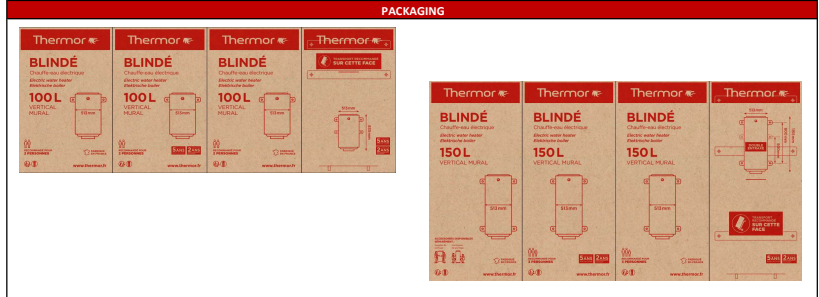

INSTALLATION DIMENSIONS

VERTICAL MOUNTED

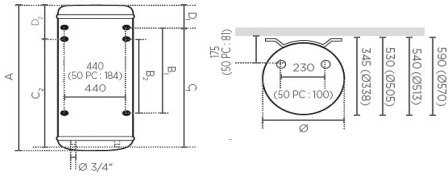

HORIZONTAL MOUNTED UNDER FITTINGS

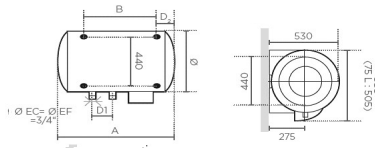

HORIZONTAL MOUNTED SIDE FITTINGS

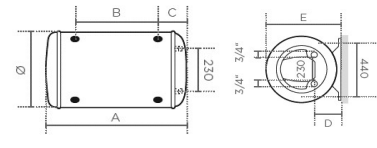

Ø 505 and Ø 513		COPPER - WALL MOUNTED																	
Code	Description	Capacity (L)	Number of person	Output (W)	QPR	Hot water at 40°C	Cooling constant	Heating time	Ø	A	B1	B2	C1	C2	D1	D2	Depth	Weight (kg)	Energy Class
241039	TH BLINDE ETROIT VM 050L 2000M	50	1	2000	1.11		0.47	1h36	338	918			750		168		345	18	C
241040	TH BLINDE VM 050L 1200M	50	1	1200	0.71		0.3	2h26	505	575			370		155		530	22	C
251054	TH BLINDE VM 075L 1200M	75	1 or 2	1200	1.06	137.2	0.28	4h12	513	705			570		135		530	22	C
261128	TH BLINDE VM 100L 1200M	100	2	1200	1.18	176.1	0.25	5h13	513	835			750	565	85	265	530	26	C
251084	TH BLINDE VM 150L 1600M	150	3	1600	1.61	279	0.22	5h50	513	1155	800	500	1050	750	105	405	530	34	C
251085	TH BLINDE VM 200L 2200M	200	4	2200	1.96	375.7	0.21	5h42	513	1475	800	700	1050	950	425	525	530	43	C

Ø 570		COPPER - COMPACT WALL MOUNTED																	
Code	Description	Capacity (L)	Number of person	Output (W)	QPR	Hot water at 40°C	Cooling constant	Heating time	Ø	A	B1	B2	C1	C2	D1	D2	Depth	Weight (kg)	Energy Class
861511	TH BLINDE COMP VM 100L 1200M	100	2	1200	1.15	182	0.24	5h28	570	740			570		160		590	29	C
861512	TH BLINDE COMP VM 150L 1600M	150	3	1600	1.49	276	0.21	6h00	570	990	500		750		230		590	38	C
861513	TH BLINDE COMP VM 200L 2200M	200	4	2200	1.83	363	0.19	5h55	570	1245	800	700	950	185	285	590	44	C	

Ø 513 and Ø 577		COPPER - HORIZONTAL MOUNTED SIDE FITTINGS																	
Code	Description	Capacity (L)	Number of person	Output (W)	QPR	Hot water at 40°C	Cooling constant	Heating time	Ø	A	B1	B2	C1	C2	D1	D2	Depth	Weight (kg)	Energy Class
853408	TH BLINDE HM 075L 2000M RACC COTE	75	1 or 2	2000	1.41	152	0.4	2h27	513	705			530				530	22	C
853409	TH BLINDE HM 100L 2000M RACC COTE	100	2	2000	1.59	192	0.34	3h15	570	740			590				590	31	C
853410	TH BLINDE HM 150L 2000M RACC COTE	150	3	2000	1.94	281	0.27	4h55	570	990			590				590	40	C
853411	TH BLINDE HM 200L 2000M RACC COTE	200	4	2000	2.38	369	0.25	6h14	570	1245			590				590	49	C

Ø 520		COPPER - HORIZONTAL MOUNTED UNDER FITTINGS														
Code	Description	Capacity (L)	Number of person	Output (W)	QPR	Hot water at 40°C	Cooling constant	Heating time	Ø	A	B1	B2	C1	Depth	Weight (kg)	Energy Class
253011	TH BLINDE HM 075L 1600M RACC DESSOUS	75	1 or 2	1600	1.09	141.9	0.31	2h59	520	700	480		545	25	C	
253014	TH BLINDE HM 100L 1600M RACC DESSOUS	100	2	1600	1.18	175.6	0.25	3h49	520	830	600		545	29	C	
253021	TH BLINDE HM 150L 2200M RACC DESSOUS	150	3	2200	1.51	253.3	0.21	3h52	520	1150	800		545	37	C	
253023	TH BLINDE HM 200L 2200M RACC DESSOUS	200	4	2200	1.81	333.2	0.19	5h07	520	1470	1050		545	45	C	

Ø 575 and Ø 750		COPPER - STABLE													
Code	Description	Capacity (L)	Number of person	Output (W)	QPR	Hot water at 40°C	Cooling constant	Heating time	Ø	A	B	C	D	Weight (kg)	Energy Class
282030	TH BLINDE VS 200L 2200M	200	4	2000	1.82	366	0.19	5h06	575	1270	270	590		47	C
282031	TH BLINDE VS 300L 3000M	300	4 or 5	2000	2.41	537	0.17	5h53	575	1765	270	590		60	C
292001	TH BLINDE COMP VS 500L 5000TC	500	5 et +	5000TC	2.6		0.11	5h53	750	1840	310	850		154	C

STABLE

